



## BLOOMSBURG'S RECYCLING CENTER

Mailing Address:

301 East Second Street  
Bloomsburg, PA 17815-1870  
(570)784-4532

Center located at:

901 Patterson Drive  
Bloomsburg, PA 17815-1870  
Fax (570) 784-3414

### Wire Mesh Containers BID SPECIFICATIONS

REQUEST FOR BID: RETURN BY 3/14/24 @ 2:00pm at which time the bids will be opened and read aloud.

Bloomsburg's Recycling Center located at 901 Patterson Drive in Bloomsburg, Pennsylvania wishes to purchase wire mesh containers for handling bulk recyclables. Containers are to be all welded steel construction with standard fork clearance. Fork pocket 6" wide x 3" high, with a 19.5" gap from inside of each fork pocket (diagram included). Minimum requirements 12 gauge steel panel, flattened expanded metal, Tubing, c-channel and angle iron to match existing bins as close as possible. 7 gauge steel for fork pockets welded to floor and frame supports. Floor must be on an incline for gravity unload discharge. Approximate weight of existing bins is 1420 lbs. Containers must be stackable without special attachments and must be painted (black).

Sealed Bids must be delivered to Town of Bloomsburg 301 East 2<sup>nd</sup> Street Bloomsburg, PA 17815 Clearly marked "Bid for Wire Containers". Bids must be received by 2pm Thursday March 14, 2024 at which time bids will be opened and read aloud. Please indicate any Co-star or other pricing discounts. Based upon the unit pricing the Town reserves the right to add additional containers or reduce the number of containers requested. The Town has the right to accept or deny the trade in of the old units.

Bidders may make arrangements to view the existing containers by contacting Charles Fritz, Recycling Coordinator at 570-784-4532 or by email [cfrtiz@bloomsburgpa.org](mailto:cfrtiz@bloomsburgpa.org).

An appendix with photos of existing containers is provided with this bid specifications.

Image 1 - bottom of bin

Image 2 - door in open position. Note the inside door panel has a one inch bended metal rim  
To allow for door to be propped open as shown with a stick

Image 3 - Side view of corner pins for stacking and nesting on top of other bins.

Image 4 - Image of the hinged top door with two (one on each side of the bottom) sliding latches

Delivery of all bins must be completed by June 25, 2024.

<u>ITEM #</u>	<u>UNIT PRICE</u>	<u>TOTAL COST</u>
1. Ten (10) 8'X8'X8' wire mesh containers with front and side forklift access and hinged front unloading door with forty-four inch opening and locking pins with a gravity sloped floor	<hr/>	<hr/>
2. Delivery to 901 Patterson Drive Bloomsburg, PA 17815		<hr/>
3. Trade - in value of old bins		<hr/>
TOTAL COST - FOB Bloomsburg Tax Exempt # 24-6000690		<hr/>

Delivery timeline 

---

Company Name and Address:

---



---



---

Signature of Representative :

---

Phone Number :

---



## BLOOMSBURG'S RECYCLING CENTER

Mailing Address:  
301 East Second Street  
Bloomsburg, PA 17815-1870  
(570)784-4532

Center located at:  
901 Patterson Drive  
Bloomsburg, PA 17815-1870  
Fax (570) 784-3414

### Wire Mesh Containers BID SPECIFICATIONS

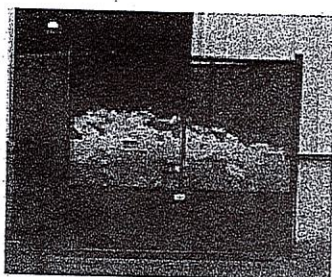

**Bottom sheet wrap**  
Around all 4 sides Approximately  
2' 4" Allow for inside bin sloped  
Floor to provide gravity empty  
toward door.

**Bottom Corner pins** to allow bins  
to be stacked into openings on  
the top four corners of the bins

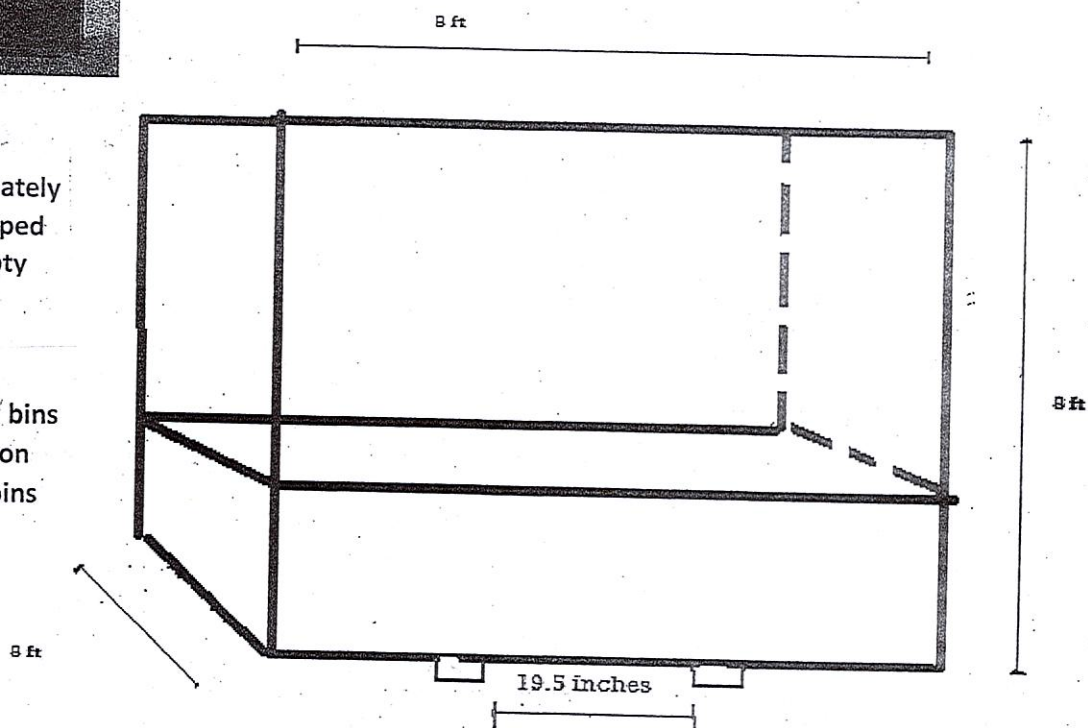

**One Swing door** 44" wide with  
hinged top

**Easy open bottom Side latches** on  
each side

**Forklift pockets**

6" wide X 3" tall

On all four sides



## Appendix

Four (4) images of existing bins

